



Fairmead Avenue, Westcliff-On-Sea

£400,000

home.

# 118 Fairmead Avenue

Westcliff-On-Sea  
SS0 9SB

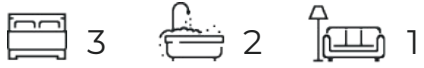

- Wonderful Three Bedroom Terraced House
- Beautifully Maintained Throughout
- Spacious Open Plan Kitchen/Diner
- West Facing Lounge
- Secluded East Backing Rear Garden
- Short Walk To London Road & Chalkwell Park

## Interested?

Give us a call or request a viewing below. Our team are always on-hand and willing to help you.

📞 01702 480 033





Home Of Leigh are proud to present this wonderful three bedroom terraced house which has been beautifully maintained throughout and benefits from a spacious open plan kitchen/diner leading out to a great size rear garden.

The accommodation comprises; entrance hall, ground floor guest cloakroom, a west facing lounge and an open plan kitchen/diner, whilst to the first floor there are three bedrooms and a modern fitted family bathroom.

Externally the property boasts a secluded east backing rear garden.

Located on Fairmead Avenue in the heart of Westcliff On Sea, this lovely family home is within a short walk up to the London Road with its array of shops and bus routes as well as Chalkwell Park.

**Accommodation Comprises:**

The property is approached via part glazed entrance door leading to:

**Entrance Hall:**

14'9 x 5'5

With stairs leading to the first floor landing, wood laminate flooring, coved cornice to ceiling, radiator, doors to:

**Ground Floor Cloakroom:**

4'6 x 2'5

Modern two piece suite comprising; low level WC, wash hand basin, wood laminate flooring.

**Lounge:**

16'8 x 12'8

Double glazed bay window to front aspect, carpeted, coved cornice to ceiling with central ceiling rose, radiator.

**Kitchen/Diner:**

18'9 x 15'1

A great size open plan kitchen with double glazed window to rear aspect and french doors to the garden. The kitchen is fitted to include a butler sink with mixer tap, inset into a range of granite work tops with cupboards and drawers beneath, built-in oven and four ring electric hob with extractor hood above, further range of matching eye level wall mounted units, concealed boiler (not tested), integrated dishwasher and appliance space and plumbing for washing machine, wood flooring throughout, coved cornice to ceiling, radiator.

**First Floor Landing:**

6'10 x 6'7

Doors to:

**Bedroom One:**

16'4 x 11'1

Double glazed bay window to front aspect, carpeted, range of fitted floor to ceiling wardrobes, coved cornice to ceiling, radiator.

**Bedroom Two:**

12'9 x 11'1

Double glazed window to rear aspect, carpeted, coved ceiling, radiator.

**Bedroom Three:**

9'7 x 6'10

Double glazed window to front aspect, carpeted range of fitted furniture and shelving, radiator.

**Bathroom:**

9'6 x 6'1

Double glazed obscure window to rear aspect, modern three piece suite





comprising; bath with mixer tap, low level WC, wash hand basin with mixer tap and vanity cupboard beneath, smooth plastered ceiling with access to loft space, tiled flooring, heated towel rail.

**Externally:**

**Rear Garden:**

The property benefits from a great size east backing rear garden which commences with a raised deck area and the remainder being laid to lawn and enclosed by screen panel fencing, garden shed to remain.





GROUND FLOOR

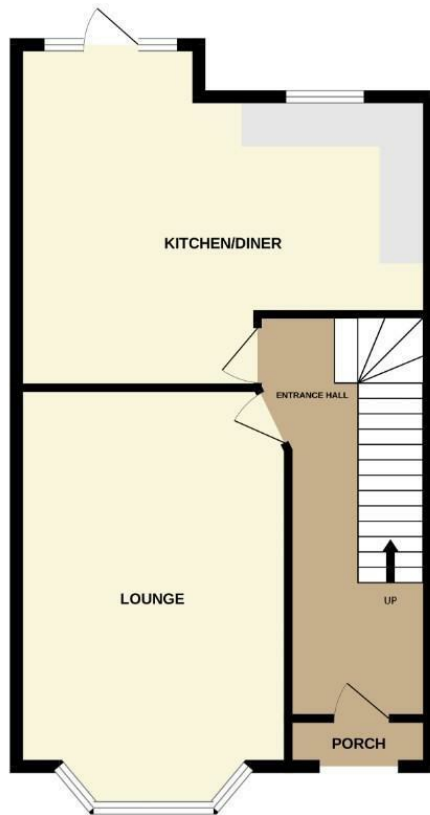

1ST FLOOR

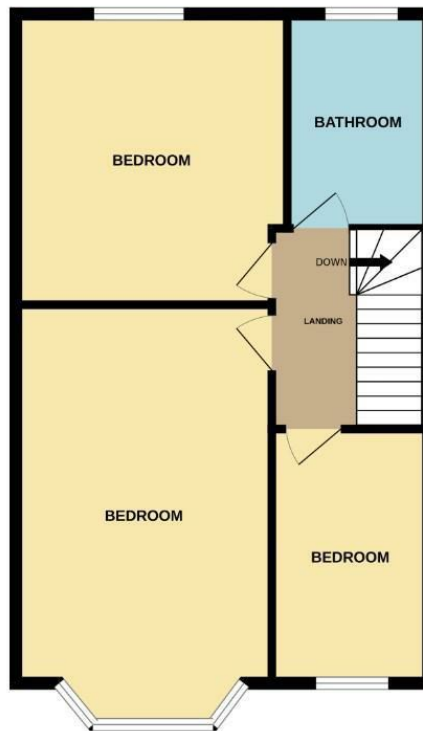

Made with Metaspix ©2026

## Property Details

3 Bedrooms  
2 Bathrooms  
1 Reception Rooms  
House - Terraced

Approx. sq ft  
EPC band: D  
Tenure: Freehold  
Council Tax Band: C

£400,000

### Interested?

Give us a call or request a viewing below. Our team are always on-hand and willing to help you.

01702 480 033

home.



Scan QR code for  
our Instagram

[homeofleigh.com](http://homeofleigh.com)

The Old Bank, 26 Broadway  
Leigh-on-Sea, SS9 1AW

01702 480 033

